



Features

The BC600 fuse clip is made of copper or high purity phosphor copper with nickel or tin plated surface. This clip shape is suited for use with the 6×30 fuse links.

- Thickness: 0.4mm or 0.5mm
- Pb- and Halogen-free, RoHS compliant
- Smooth Surface
- Soldering temperature: 260±5°C
- Nickel plated or bright tin plated

Dimensions (unit in mm)

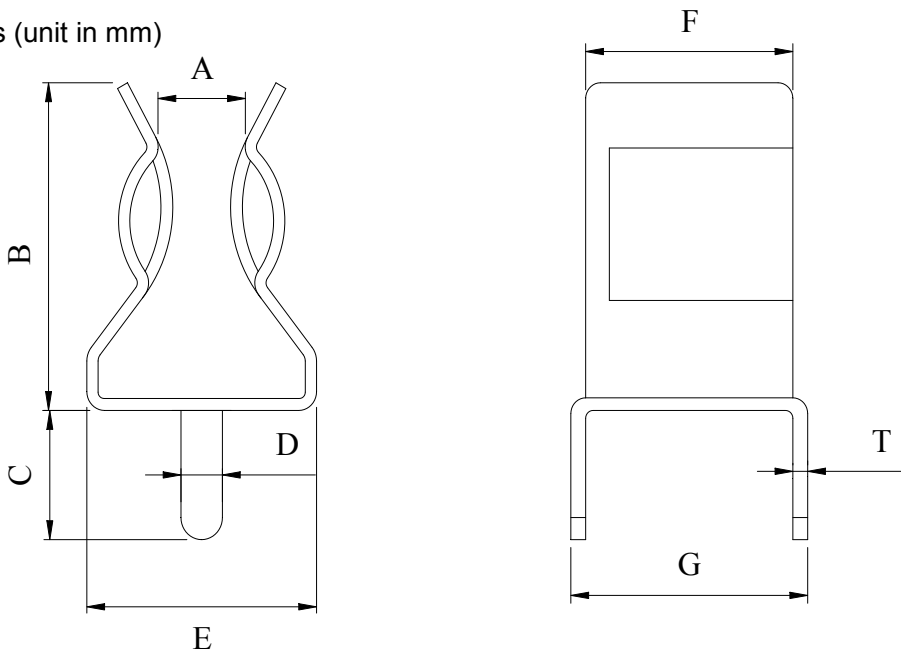

Model Item	Dimensions (unit in mm)								Material	Hardness	Coating
	A	B	C	D	E	F	G	T (Thickness)			
BC600-040	3±0.3	10.4±0.2	3.5±0.1	1.4±0.1	7.8±0.2	7.0±0.1	8.0±0.2	0.4±0.03	Copper H62	Hard	Nickel
BC600-050	3±0.2	10.4±0.2	3.6±0.2	1.4±0.1	7.8±0.1	7.0±0.1	8.0±0.2	0.5±0.03	Copper H62	Semihard	Nickel
BC600-050B	3±0.2	10.4±0.25	3.6±0.2	1.4±0.1	7.8±0.2	7.0±0.1	8.0±0.2	0.5±0.03	High purity phosphor	Semihard	Nickel
BC600-250	3±0.2	10.4±0.2	3.6±0.2	1.4±0.1	7.8±0.1	7.0±0.1	8.0±0.2	0.5±0.03	Copper H62	Semihard	Bright Tin
BC600-250B	3±0.2	10.4±0.25	3.6±0.2	1.4±0.1	7.8±0.2	7.0±0.1	8.0±0.2	0.5±0.03	High purity phosphor	Semihard	Bright Tin

Ordering Information

Series	Part No.	Packaging Code	Qty
BC600			